



Jiwaji University

Gwalior

(NAAC Accredited "A" Grade University)

Atal Bihari Vajpayee International Convention Centre- At a Glance



UNIVERSITY AT A GLANCE

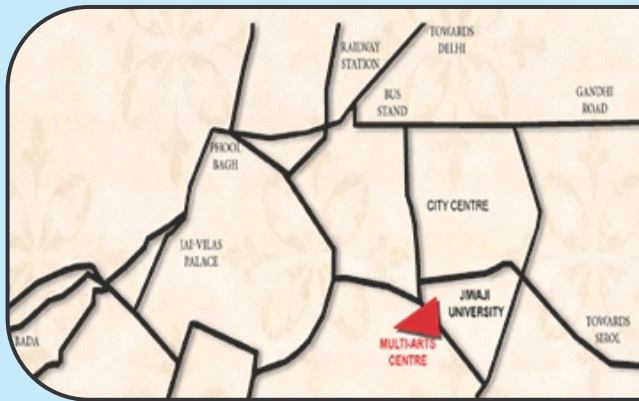

University is located in the heart of City

- ¥ Just 5 Minutes from Bus Stand.
- ¥ Just 5 Minutes from Railway Station.
- ¥ Just 15 Minutes from Airport.
- ¥ Located on 100 feet wide road, easily approachable to important location.
- ¥ Just 5 Minutes from Highcourt & New Collectorate.

Jiwaji University Gwalior came into existence on May 23, 1964, through M.P. Govt. Ordinance no. 15 of 1963. Late Dr. Sarvapalli Radhakrishnan, the then President of India, laid the foundation stone on 11th December 1964 at a sprawling campus of over 225 acres of land at Naulakha Parade ground. This was a generous contribution of Scindia family, in particular Kailashwasi Maharaja Shrimant Jiwajirao Scindia and late Rajmata Shrimati Vijayaraje Scindia. The institution was christened after the name of Kailashwasi Shrimant Jiwajirao Scindia as a standing memorial to his persona. The motto of the university is embedded in its logo “विद्यया प्राप्यते तेजः”

Vision

Our ability to enhance well-being of the people by educating, creating knowledge and serving society by putting the knowledge to work with excellence. To advance the professional competence of youth and inculcate in them the urge to recognize challenges as opportunities.

Affiliated Colleges

Jiwaji University affiliates more than 417 Govt., Govt. aided and Private Colleges with a total enrollment of more than 2.5 lakh students. Jiwaji University aims to lead the nation in research and education. We seek to do this in ways which benefit society on a national and a global scale.

Ranking

- Jiwaji University is ranking 101 out of 877 Indian universities (**Unirank**).
- **QS** World University ranking for Jiwaji University: Overall rank in India 86-90.
- Scimago Institutional Ranking (**SIR**) for Jiwaji University is 451 out of 6459 ranked institutions.



Areal View



Interior View

Atal Bihari Vajpayee International Convention Centre



Bharat Ratna – Shri Atal Bihari Vajpayee

Jiwaji University, Gwalior is renowned for the excellence, impact and distinctiveness for its research-led learning and teaching. It is a prestigious state university of Central India.

For accommodating its various activities, this convention centre has been developed by university, named after former Prime Minister Shri Atal Bihari Vajpayee with the state of art infrastructure, suitable for large gathering for academic, social and cultural activities.

Shri Atal Bihari Vajpayee was born on 25th december 1924 in Gwalior. He did his B.A. degree from Maharani Laxmi Bai Govt. College of Excellence. He was a writer politician and a poet. He was awarded Padma Vibhushan in 1992 and awarded Bharat Ratna in 2015. He was Prime Minister of India for three times. He was a member of Parliament for Five Decades. Jiwaji University feel honoured to dedicate this convention Centre to his memory

The Centre Comprises of:

Main Auditorium: Having around 2000 sitting capacity and three seminars halls having 100 sitting capacity each. It also has an art gallery and amphitheater. The Landscape area, Gardens and enough parking space makes it suitable for other outdoor activities of the university and society.



AMPHITHEATRE

- Open Air Auditorium is an open-air venue used for entertainment, performance, and Sports.
- Seating capacity of around 1500 with 11.50 metres diameter of stage.
- Underneath the seating there is an exhibition gallery of 700 sqmts. Having provision of multi-level display area, discussion lounge, office, stores and general amenities etc.
- Contemporary amphitheatres often include standing structures, called bandshells. sometimes curved or bowl-shaped, both behind the stage and behind the audience, creating an area which echoes or amplifies sound, making the amphitheatre ideal for musical or theatrical performances. Small-scale amphitheatres can serve to host outdoor local community performances.



Conference Hall



Exhibition Hall

- For exhibitions we have a hall in basement of around 1150 sqmt., with proper equipped facilities, Hall can be accessed by van or lorry with two ramp going towards the Basement with essential services such as data and electricity.
- From an intimate banquet for ten to a gala dinner for 2000, we have provided perfect spaces for award ceremonies, conference banquets, gala dinners, parties and private functions.



Banquet Hall

FEATURES OF MAIN AUDITORIUM

- Meeting rooms, most of which are flooded with natural light and wonderful views over the city skyline, offer the perfect solution for board meeting, corporate meetings, training sessions, interviews and supplier meetings, coupled with the additional flexibility of using them from break-out meetings. These rooms come in a range of different sizes room layouts including theatre style, boardroom, class room and banqueting.
- The Auditorium at the Multi-art complex is one of Gwalior's most exciting entertainment venues with a full theatrical stage, sound and lighting systems, plus tiered seating for 2000
- We have the perfect choice of rooms and halls for your conference, with a tiered auditorium plus four board rooms and 11 other rooms for break-out sessions.
- We have the audio & video conferencing display for corporate & educational conferences & meetings.

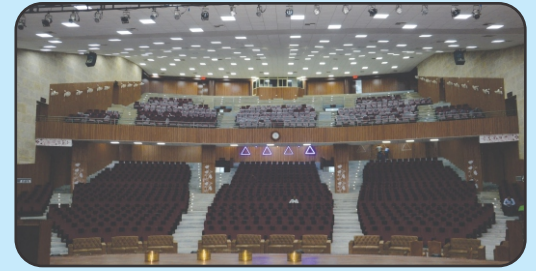

Video Conferencing



Meeting Hall

FEATURES OF MAIN AUDITORIUM

- Seating capacity of more than 2,000 people.
 - Perfect for cultural & social events, fairs as well as conventions large meeting etc.
 - Large wooden flooring stage of 300 Sqmt. & backstage of 230 Sqmt with musician pit and hydraulic lift with all modern Lighting & Sound System.
- Green rooms for both male & female.
- Equipped with the latest technologies
 - Our wonderful foyer space of the building, bring light and space to every event. Used by clients delegate registration, hospitality and receptions, these spaces offer an additional dimension to enhance your event, as you advance throughtout the building, the views just better and better.
 - Foyer & Lobby space of 1500 Sqmt.
- To accomodate large number of people.
 - lifts are provided for easy access.
 - Multi-purpose modular & flexible spaces.
 - Seperate toilets are provided for male & female.



Stage

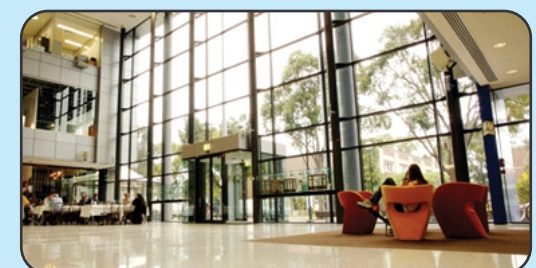

Foyer

Other Amenities

- 24x7 Secured Campus & CCTV etc.
- Lavish Green Rooms.
- Modern Washrooms.
- Fire Fighting Equipped.
- Fully Air Conditioned.
- 24 Hours Power Supply.
- Maximum Green Space & Open Area.
- Easy Access through Lifts.
- Suffiecient Storage Area.
- Ample Parking Sapace.
- Wide Roads in the Complex.
- Complex is Situated at Prime Location.

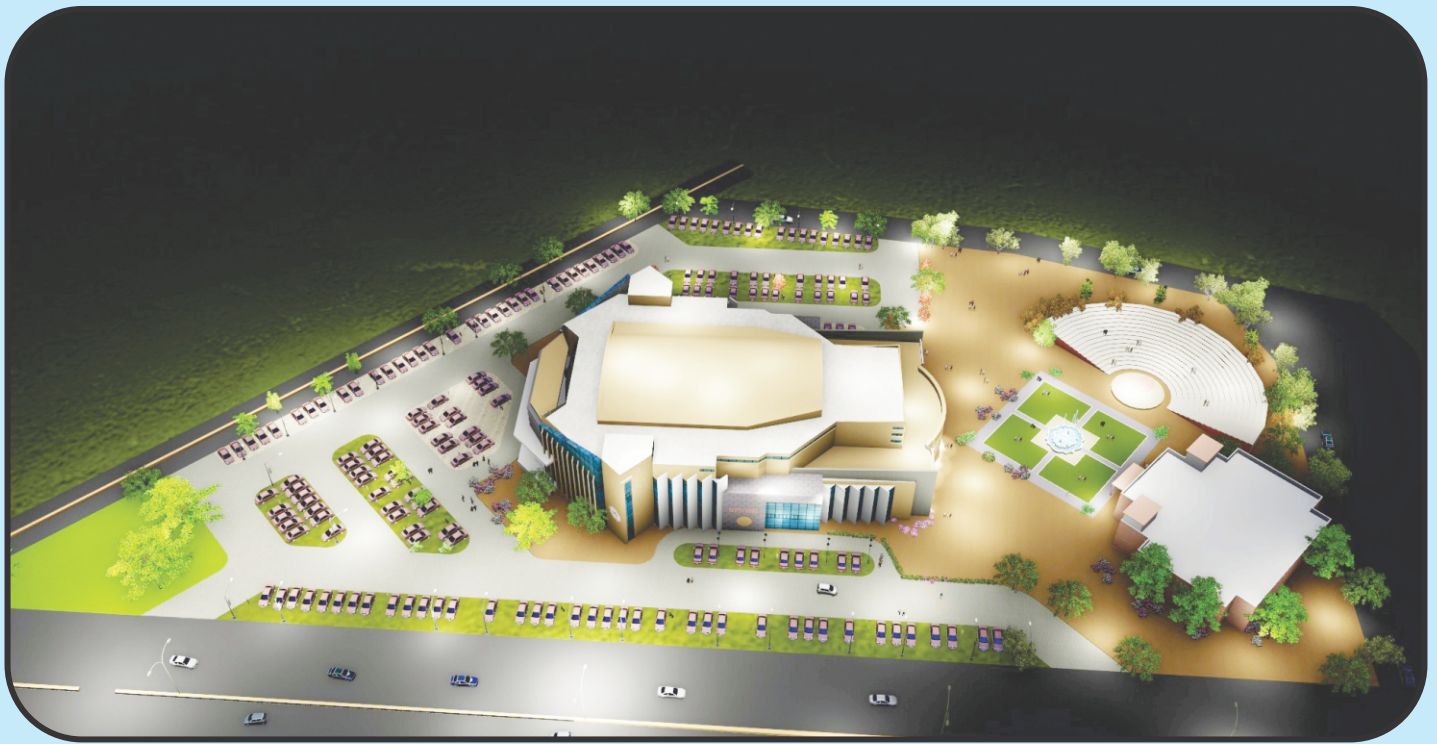



Open Air Auditorium



View of Convention Centre

About Gwalior



A town that beckons visitors with its history and romance. It is surrounded by vast, unending plains that are sporadically dotted with hills, all of which are covered with a carpet of green after the first monsoon rains. The city is a well acknowledged place of music and arts, associated with historic as well as contemporary evidence. The city plays a significant role among all major trade and industrial developments of the central India with urban population of more than 20 lacs. The city education strength comprises of 7 universities of various specialized streams with many renowned colleges and schools. The city is also marked as a Counter Magnet City of the National Capital, New Delhi.



Jiwaji University

Gwalior

(NAAC Accredited "A" Grade University)



Published by:

Registrar, Jiwaji University, Gwalior, Madhya Pradesh-474011

Phone: 0751-2442801, Website: www.jiwaji.edu